

The ultimate in compactness and operational capab



$I_{CW, 1s} = I_{CS}$ for all *TemPower2* ACBs.

TemPower2 is the world's first "Double Break" ACB, having two breaking contacts per phase. The unique pole structure means that the short time withstand rating (I_{CW} , 1sec) is equal to the service short-circuit breaking capacity (I_{CS}) for all models. Full selectivity is guaranteed up to the full system fault level. *TemPower2* ACBs have the world's smallest depth resulting in space saving in switchboards.

More than twenty design patents have been registered for the *TemPower2* ACB.

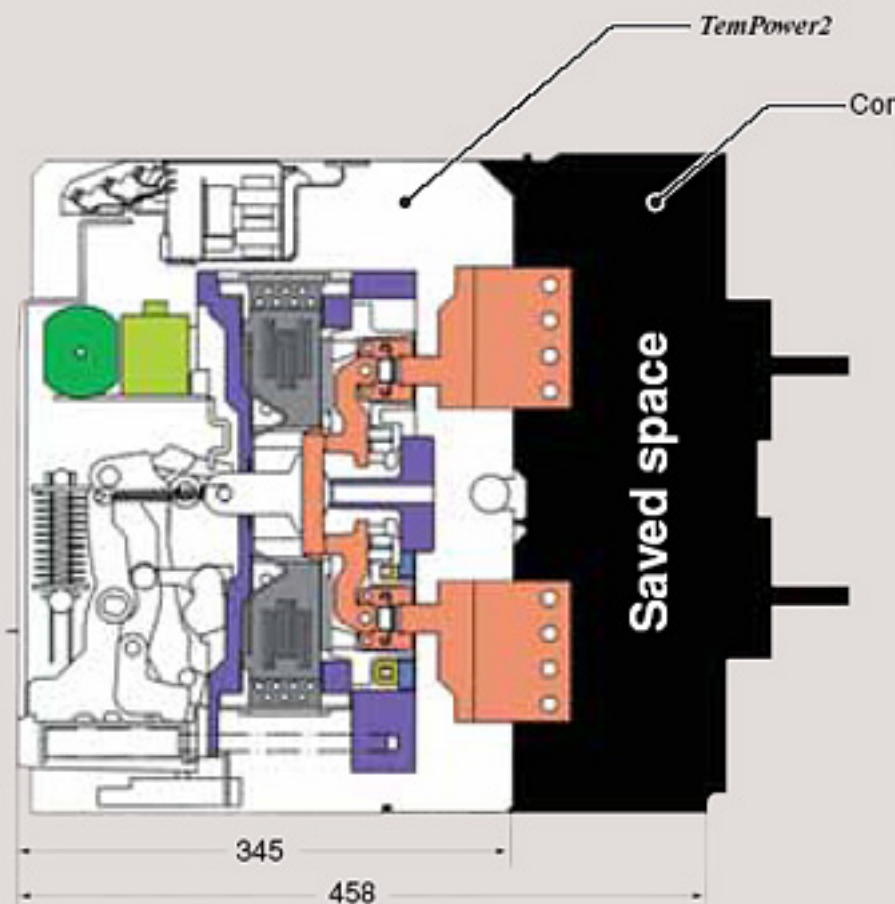

Terasaki's core business belief is commitment to our customers and the progressive innovation of the *TemPower2* AR ACB. With this in mind we are introducing our new AR440SB (Compact) 4000A ACB and new AR5000A and 6300A ACB. With the introduction of these new ACBs there will be a solution from 800A to 6300A all with the same front cover dimension and standardized accessories throughout the range. Maximum power from minimum volume was central to the design specification. With a depth of 290mm for the fixed type and 345mm for draw-out, it is one of the smallest ACBs in the world. ACBs with front connections are available off-the-shelf. Front connections are especially suitable for smaller-depth switchboards.

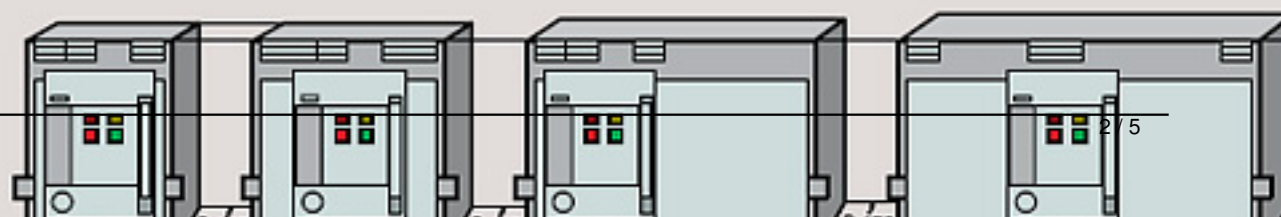



Increased accessibility from the front

It enhances ease of installation, operation, and maintenance.

Connection to the main circuit
(for front connections)

Accessory fitting
(Removing the front cover enables
replacement of internal parts.)

The double insulated design ensures that most accessories can be safely and easily installed by the user. Control, auxiliary and position switch terminals are mounted at the front on the ACB body for easy access. Horizontal, vertical and front terminal connections, can also be changed by the user for any last minute alterations. Due to the increased level of harmonics within the distribution network, the neutral phase is fully rated as standard.



Connection to the control

Manual operation

Breaker fixing bolt
(optional)

Draw-out operation



No extra arc space required, vertical stacking permitted

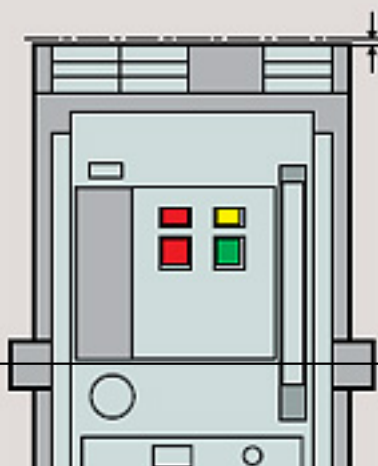

No extra arc space required

The *TemPower2* ACB dissipates all arc energy within its unique “*DoubleBreak*” arc chamber. The internal energy dissipation within the ACB allows the clearance distance of the ACB to nearby earthed metal to be



Replacement of the main contacts

The fixed and moving main contacts can be replaced in the field, thus prolonging the life of the circuit breaker. Changing each pole takes around 15 minutes.

